

DURA CLUTCH INSTALLATION 15-555-RANGER 570-B DCS

SVI, LLC 08MAY2023

KIT PART #: 15-555

MODEL: DC-RANGER 570-B DCS

DESCRIPTION: MY22-CURRENT RANGER 570 with P190X Clutches-Transmission part #'s 1334612 & 1334588

KIT CONTENTS:

1. 10-127 ASM-DCPRIM WT10-099 0SPR50-001
2. 75-094 SCREW-CLUTCH 7/16-20X8 GR8
3. 25-164 WASHER-SHOULDER
4. 10-273 ASM-DC SECONDARY 9.5 PREM ROLL
5. 35-025 BELT
6. 75-088 SCR-HXFL-M8X1.25X75 10.9 ZPC
7. 90-059 WSHR-DOMED SMALL 0.338X1.190X0.080 ZY
8. 90-011 WASHER-5/16 SPRING LK-MED ZY
9. 99-023 LOCTITE 243 0.5ML CAPSULE
10. 30-091 TOOL-BELT INSTALL
11. 10-254 ASM-CLUTCH COVER OUTER
12. 97-018 DECAL-DC CLUTCH HOUSING DASH 35-025
13. 98-042 OWNERS MANUAL SUPPLEMENT
14. 98-042 DURA CLUTCH WARRANTY
15. 98-085 INSTALLATION INSTRUCTIONS 15-555 (THESE INSTRUCTIONS)

DURA CLUTCH INSTALLATION

1. Remove lower shock bolt and nut and nut on rear stabilizer tube. This step is needed to remove old cover and install the new cover.

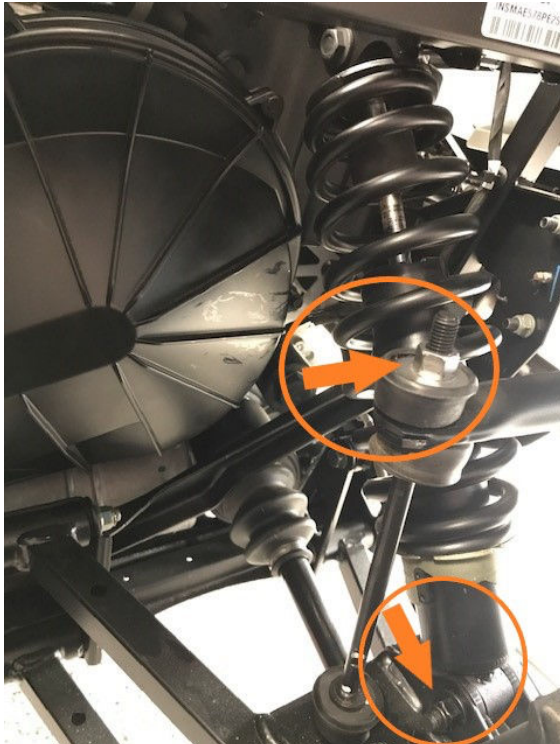

2. Remove clutch cover and Secondary clutch.

3. Install DURACLUTCH Secondary. Use new secondary screw and washers. Place a drop of BLUE Loctite provided with kit on the new secondary bolt threads. See below for washer orientation. Tighten bolt to 27 ft-lbs.

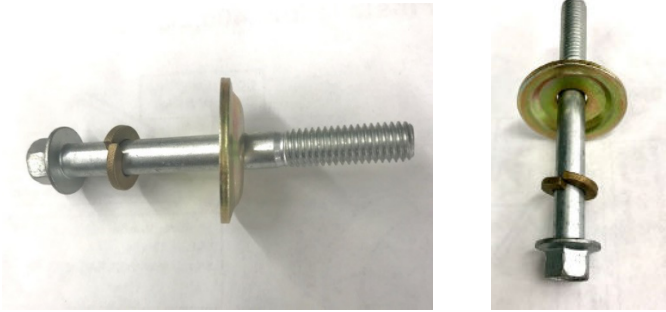

4. Remove Primary clutch bolt. Remove the Primary clutch with puller SVI 99-030. Greasing the end of the puller slightly will aid in removal. Do not get grease on any clutch components.
5. Clean the engine tapered shaft and Primary clutch bore with alcohol or degreaser. Do not lubricate.
6. Slip the belt into the Secondary so you can read the part number on the belt and using Belt Install Tool open secondary so belt will seat down into clutch. Sometimes a screwdriver is needed to assist lowering into clutch.



7. Slide belt into primary clutch, then install on post.



8. Install DURACLUTCH Primary screw with shoulder washer as shown. DO NOT USE the O.E. flat washer or lock washer. The flat washer will interfere with the primary cover. Tighten bolt to **60 ft-lbs. VERY IMPORTANT- Over tightening will not allow clutch to operate properly and cause damage and failure of the clutch.**

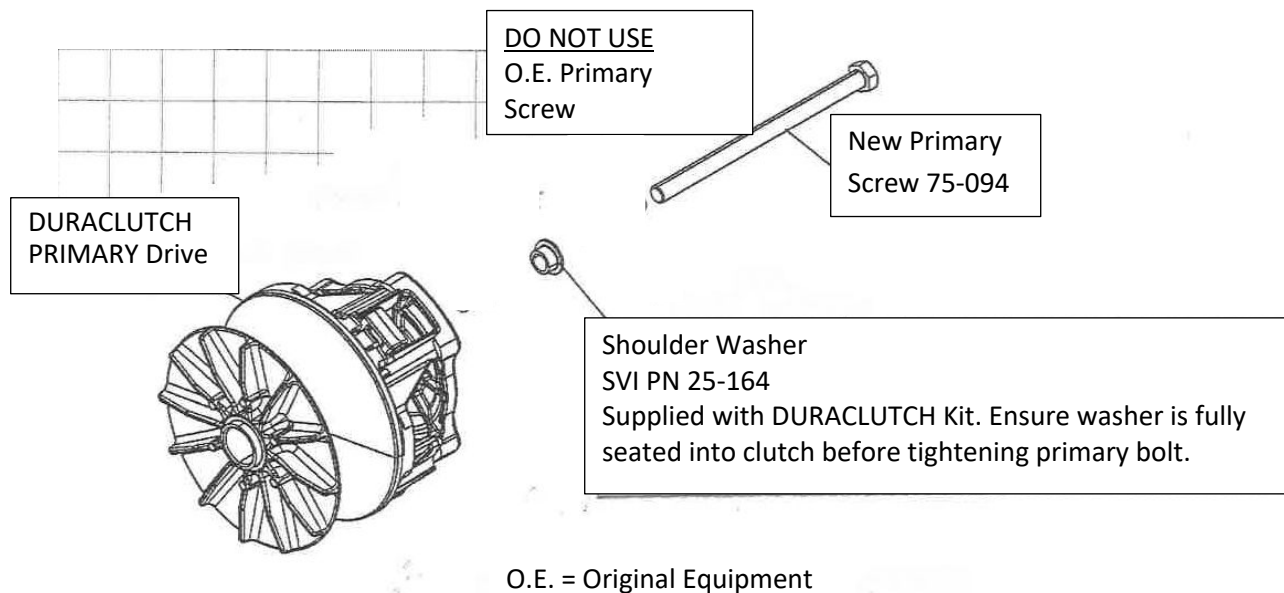

9. How to install the Belt as follows if the Primary and Secondary are already installed. Place Belt in the Primary and open the Secondary sheaves with the Belt Installation Tool provided (see photo). Roll belt into the Secondary sheaves. Sometimes a screwdriver is needed to seat lower into clutch.

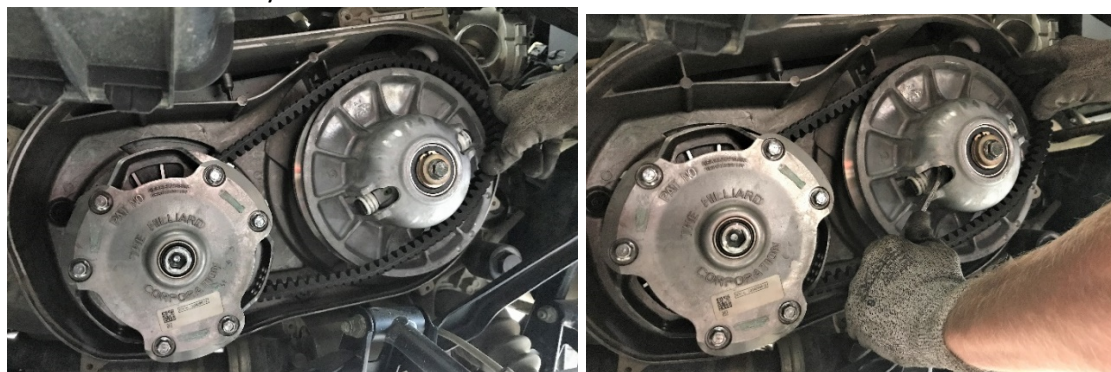

10. Once primary is torqued, with transmission in PARK, spin secondary clutch back & forth a few times to allow belt back to top of secondary.
11. Install New outer clutch cover provided with kit.
Note: The clutch cover screws are hi-lo screws designed for plastic ($\frac{3}{8}$ " drive). They can be used over and over in the same hole but must not be over-torqued.
Torque spec: 4 ft-lbs/48 in-lbs. This is like a screwdriver torque. Use a hand wrench or a clutch screw gun at a very low setting.

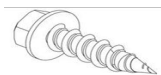

12. Install lower shock bolt and nut on rear stabilizer tube removed in step 1.

Ensure seal is good or replace with SVI PN 35-045. The DURACLUTCH primary is slightly larger than the original equipment primary. To ensure the primary does not rub against the cover push up and back on the housing while lightly snugging the bottom screws. Then tighten the top rear screw followed by the other top screws. Then tighten all remaining screws including the bottom screws evenly. After starting the engine if you hear the primary rubbing, push on the cover while the engine is running in different directions to see which way will eliminate the rubbing. Stop the engine and loosen the housing screws and retighten using the above sequence while pushing on the cover in the direction that eliminated the rubbing. If this does not eliminate the rubbing, try installing a new 35-045 gasket and go through the bolt tightening sequence again.

13. Drive vehicle for 5 miles to break-in DURACLUTCH kit components. During 5-mile drive, stop approximately 10 times and pause for 30 seconds, leave in High gear, and have foot on brake. This allows clutch packs to properly wear-in.
14. NOTE: If the transmission still shifts hard after break-in there are likely issues other than drag in the clutches. See your dealer or call DURACLUTCH service (218-967-8205).

DECALS

15. Apply two decals as shown – one on the clutch housing and one on the dash. Clean surface with alcohol or similar solvent. Decal application is important to alert service technicians that the standard Polaris clutches have been replaced.

